

Table of Contents:

<u>SAFETY AND SERVICE.....</u>	<u>1</u>
Operational Safety	1
Location	1
Ambient Temperature	2
Electromagnetic Compliance	2
Service.....	2
Cleaning	2
Delivery Contents	3
Specifications	3
<u>DESCRIPTION AND START UP</u>	<u>4</u>
Assembly instructions	4
Connections and Controls.....	5
Connection to a sound card	6
Operation and Handling	6
<u>SERVICE</u>	<u>7</u>
First Aid by Malfunction.....	7
Do You Require additional Support?.....	8



Device 

At the end of its life, the appliance must not be disposed of in household rubbish.
Enquire about the options for environmentally-friendly disposal

Copyright © 2005

All rights reserved.

This manual is protected by copyright laws.

The company **Medion®** is the owner of the copyright.

Trademark:

All appearing trademarks are the property of their respective owners.

Technical specifications and optical characteristics are subject to change without notice.

Printing errors might occur.

SAFETY AND SERVICE

Please read this chapter carefully and follow all instructions. In doing so you will ensure the reliable operation of and a long life cycle for your multimedia active loudspeakers. Keep the manual close to your loudspeakers. Store the manual safely; so that you can pass it on to the new owner should you sell your multimedia active loudspeakers.

OPERATIONAL SAFETY



- **Never open the housing** of the multimedia active loudspeakers or the power adapter! There is life threatening danger by electric shock, if the housing of the power adapter is opened. There are no serviceable parts inside.
- **Children** should **never** play **unattended** with electrical equipment. Children cannot always recognize potential hazards properly.
- These loudspeakers are **not** designed for operation in a **heavy industry environment**.

LOCATION

Follow these instructions to connect your multimedia active loudspeakers properly:

- ▶ A **power outlet** must be close to the device and **easily accessible**. Run cables in a way that no one can step or **trip** over them.
- ▶ The power feed to your device is interrupted **only**, when the **power plug is removed from the power outlet**. If you switch off the device using the power switch, then the power feed is **not interrupted**. Always hold the plug when removing. To avoid damage never pull the power cord.
- ▶ Operate the power adapter only on grounded outlets with **AC 240V~, 50 Hz**. When in doubt about the power type at the location, contact the related power utility company.
- ▶ To avoid damage **never place objects on the power cord**.

- ▶ Do not expose your loudspeakers and all connected devices to **humidity**. Avoid **dust, heat** and **exposure to direct sunlight** to prevent operating failures.
- ▶ Place and operate all components on a stable and flat surface, free of vibrations, to prevent the loudspeakers from tumbling.
- ▶ Provide a suitable ambient temperature:

AMBIENT TEMPERATURE

- ▶ The loudspeakers can be operated in an ambient temperature range between **0° C to 40° C** and a relative humidity between **20% - 80%** (non-condensing). When switched off the loudspeakers can be stored between -20° C and 70° C and at a relative humidity between 20% - 90% (non-condensing).

ELECTROMAGNETIC COMPLIANCE

- ▶ The **guidelines** for electromagnetic compliance (EMC) **must be obeyed** when connecting.
- ▶ Keep a **distance** of at least one meter from **sources of** high frequency or magnetic **interference** (TV sets, other loudspeakers, mobile phones, etc.) to avoid malfunction and data loss.

SERVICE

Please contact our service centre should you experience technical problems with your device. Repair is **solely** reserved for our **authorized service partners**.

Remove the power plug and contact our service organization, if...

- ▶ fluid has penetrated the inside of the loudspeakers.
- ▶ the speakers do not operate properly.
- ▶ the device has fallen down or the housing is damaged.

CLEANING

- ▶ Clean the multimedia active loudspeakers with a damp towel. Do not use solvents, aggressive or aerosol detergents. .

DELIVERY CONTENTS

Please check, whether the shipment is complete and inform us within 14 days of purchase should it not be. With your multimedia active loudspeakers you receive the following items:

- ▶ 2 multimedia active loudspeakers
- ▶ power adapter
- ▶ this manual
- ▶ warranty documents

SPECIFICATIONS

Speaker Type	Multimedia, active
Power adapter	KA23D 1400800 16K
Input	240V~50Hz
Output	14V~ 800mA
Connection	3.5 mm Stereo-jack for Line out / Speaker out

DESCRIPTION AND START UP

ASSEMBLY INSTRUCTIONS

You have to mount the supplied bases to the loudspeakers, before you can use your new active speakers. Please refer to the following drawings.

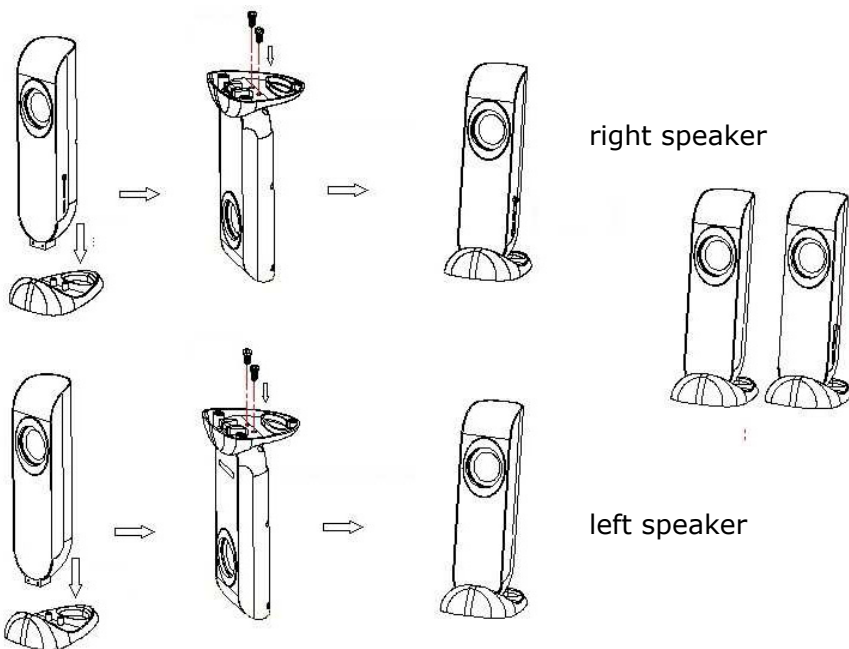

CONNECTIONS AND CONTROLS

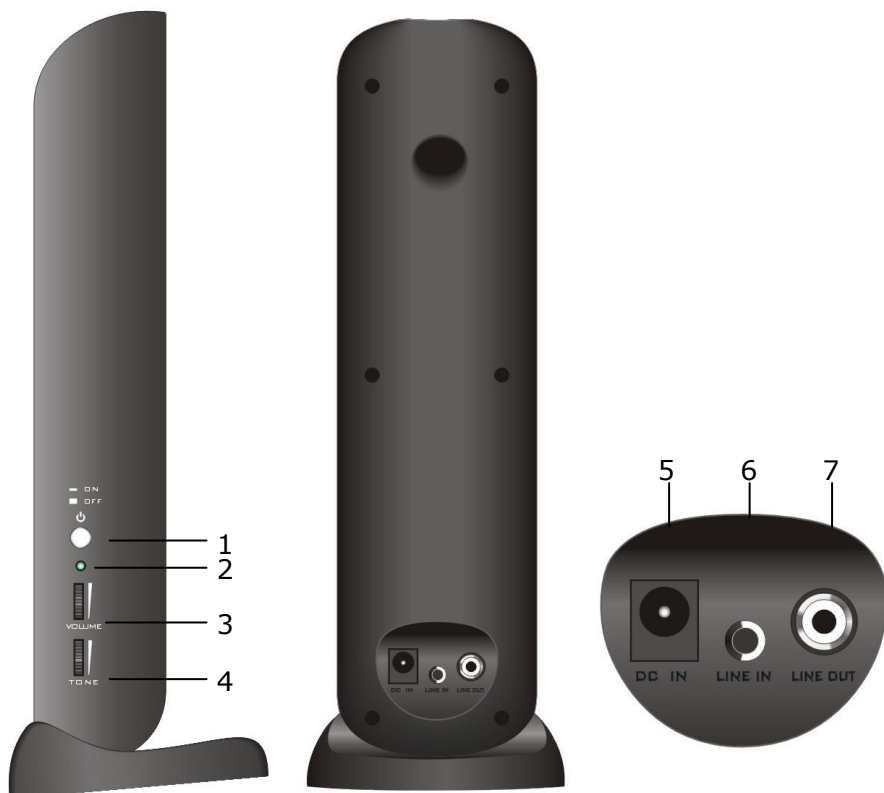

- 1 - On / off switch
- 2 - Status indicator
- 3 - Volume control
- 4 - Sound control
- 5 - AC-in connector
- 6 - 3.5 mm stereo plug for line-in
- 7 - Connector for the second speaker

CONNECTION TO A SOUND CARD

1. Note the instruction in chapter „**Safety and Service**“ (pages 2 and following)
2. Position the computer and the loudspeakers in such a way that you can work on them comfortably and safely.
3. Switch on the computer and all connected peripheral devices (monitor, printer, external modem, etc.) and wait until the operating system has started completely.
4. Now connect the loudspeakers to connection [7] together.
5. Locate the loudspeaker output on the **sound card** of your computer. This is usually marked with **Line out** or **Speaker out** and will generally be identified by its **green** colour. Read the operating instructions of your computer in the case of doubt.
6. Connect the end of the connection cable of your loudspeakers to the respective output of your computer.
7. Connect the supplied power adapter to the AC In connector of your loudspeakers [5] and insert the power plug into an easily accessible power outlet.
8. Switch on your loudspeakers with the On/Off button [1].

OPERATION AND HANDLING

You switch the loudspeakers on or off again with the On/Off button [1]. The fact that the loudspeakers are in operation is indicated by an LED [2].

Please turn the volume control below the On/Off button [3] to be able to set the volume.

The [4] tone control gives you the possibility of setting the tone according to your preferences.

FIRST AID BY MALFUNCTION

Malfunction can sometimes be caused by trivial issues and sometimes be complex in nature and require thorough analysis.

- ▶ Start with a careful visual inspection of all cable connections. If the indicators are not lit, then check, whether the multimedia active loudspeakers are properly supplied with power.
- ▶ Switch off the computer and check all cable connections. When you are certain, that the supply of power operates flawlessly and that all connections are made, then switch on the computer again.
- ▶ The connection cable of the loudspeakers must be connected to the output of the sound card (Line out or Speaker out).
- ▶ If the sound is distorted or too low, the please adjust the volume control [3] until the desired volume has been found.
- ▶ If you do not hear any sound, then this could be caused by:
 - the speakers are without power
 - the volume control is turned down
 - sound output via the computer is deactivated, muted or faulty (wrong format).

You can check the loudspeakers by connecting the connection cable at the earphone output of a CD-ROM drive and playing a music CD.

DO YOU REQUIRE ADDITIONAL SUPPORT?

If the suggestions in the previous section did not solve your problem, please contact us. It would help us a lot, if you could supply the following information:

- ▶ The configuration of your computer
- ▶ Do you use any other peripheral devices?
- ▶ Which messages are displayed on the screen?
- ▶ Which software were you using when the error occurred?
- ▶ Which steps have you already taken to solve the problem?
- ▶ If you received a customer number, please supply it to us.